

KALDEWEI

**DICHTSET FLEX | SEALING KIT FLEX | KIT D'ÉTANCHÉITÉ FLEX
SET PER SIGILLATURA FLEX | JUEGO DE ESTANQUEIZACIÓN FLEX**

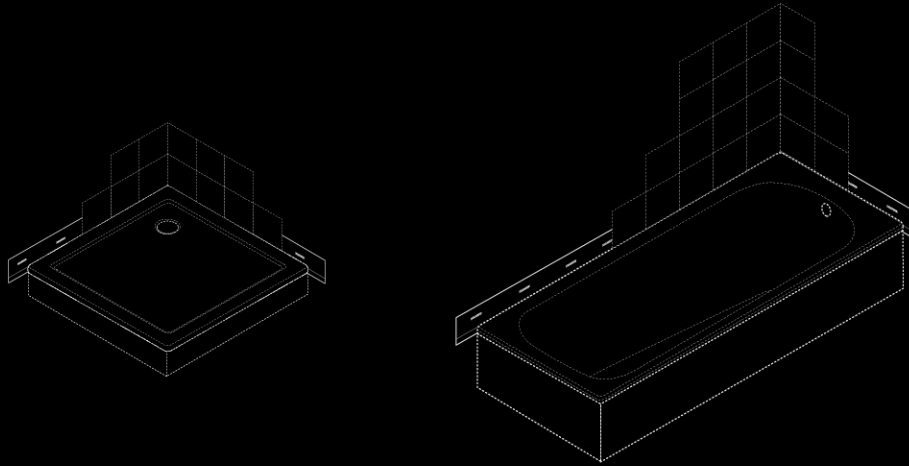

2

DE Montageanleitung | EN Installation instructions

NL Montagehandleiding | FR Instructions de montage | IT Istruzioni di montaggio
ES Instrucciones de montaje | PT Instruções de montagem | DA Monteringsvejledning
NO Monteringsanvisning | SV Monteringsanvisning | FI Aseennusohje | ET Paigaldusjuhised
LV Montāžas instrukcija | LT Montavimo instrukcija | PL Instrukcja montażu | CS Návod k montáži
RU Инструкция по монтажу | UK Інструкція з монтажу | SK Návod na montáž | HU Összeszerelési utasítás | RO Instrucțiuni de montare | SL Navodila za montažo | HR Upute za montažu
BG Ръководство за монтаж | EL Οδηγίες συναρμολόγησης | TR Montaj talimatı | AR بيكيكرتلا ليلد
ZH 安装说明书 | JA 設置説明書 | KO 조립설명서 | ID Petunjuk perakitan | TH คำแนะนำในการติดตั้ง
VI Hướng dẫn lắp ráp | HI स्थापना निर्देश

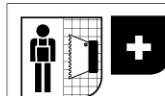
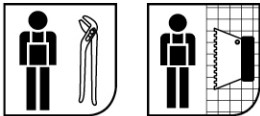
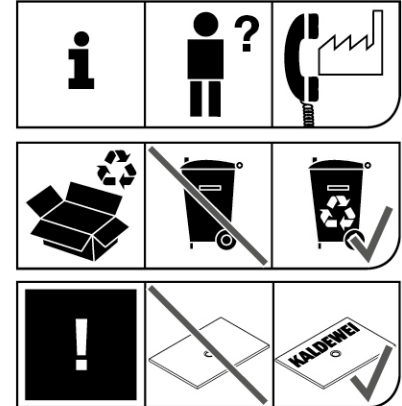
1.**2.**

DIN EN 18 157
DIN 52 460
DIN 18 534



DICHTSET FLEX

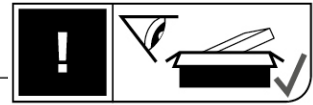

A

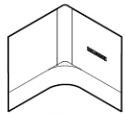
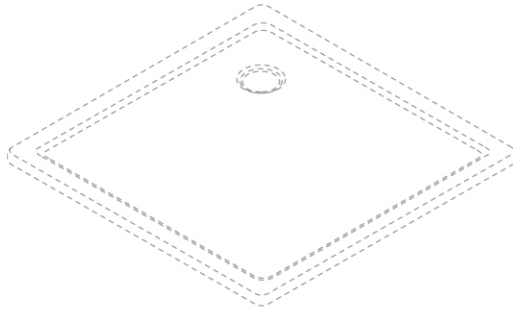

2x



5,0 m



1



2

WAS 70



Inch = mm x 0,0394

B

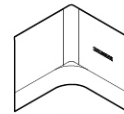
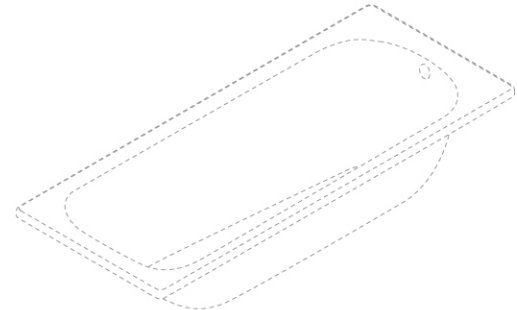
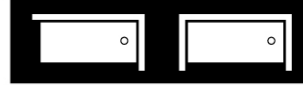

2x



5,0 m



1

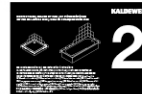

2

WAS 70



Inch = mm x 0,0394

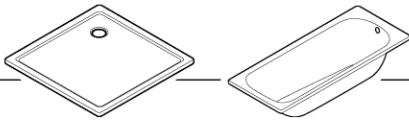
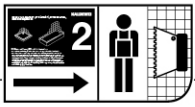

3.

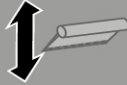
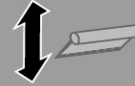
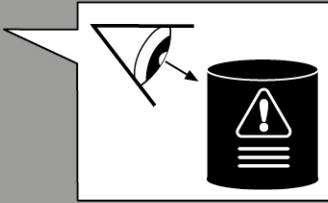
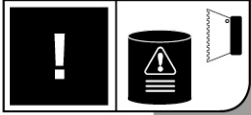

		A	S.5
		B	S.19

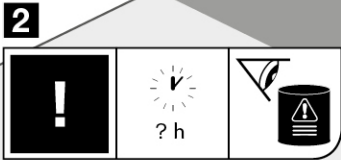

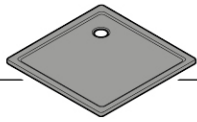

A 4.

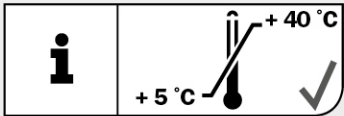
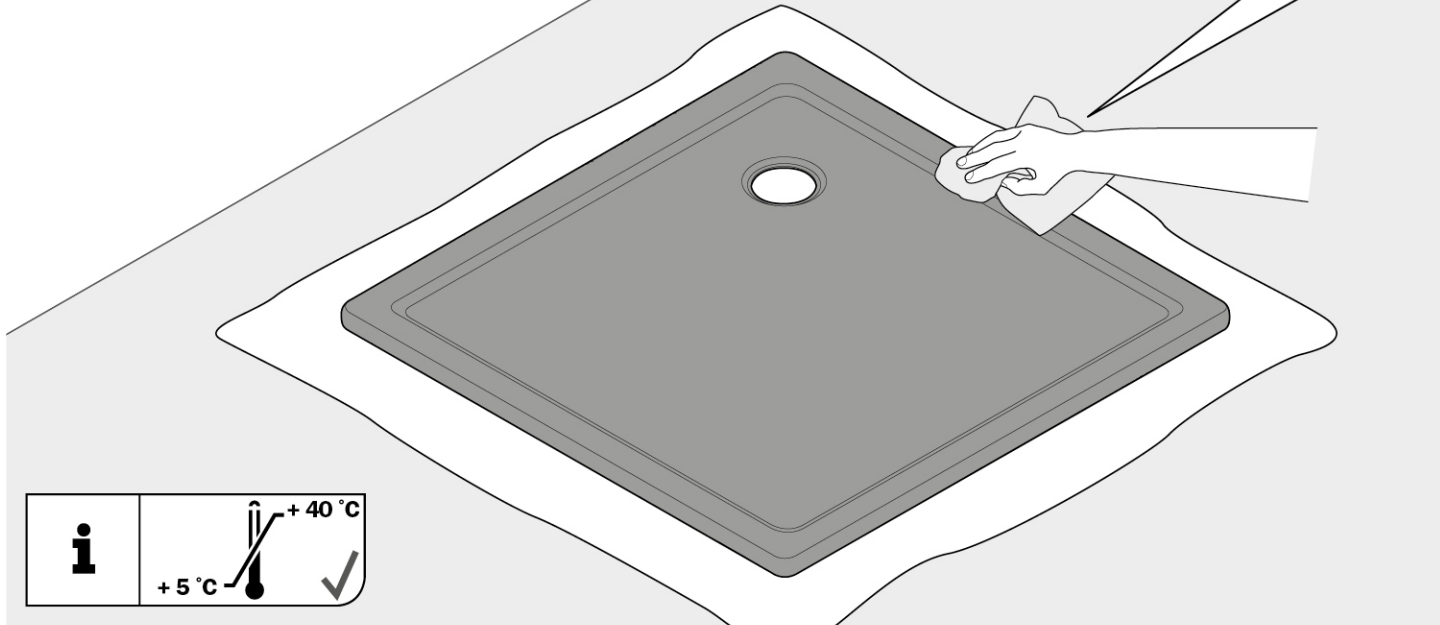
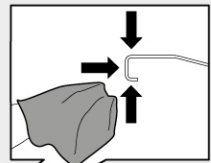
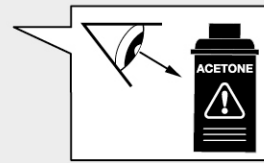
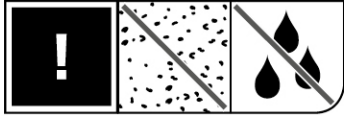

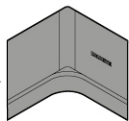

A 5.

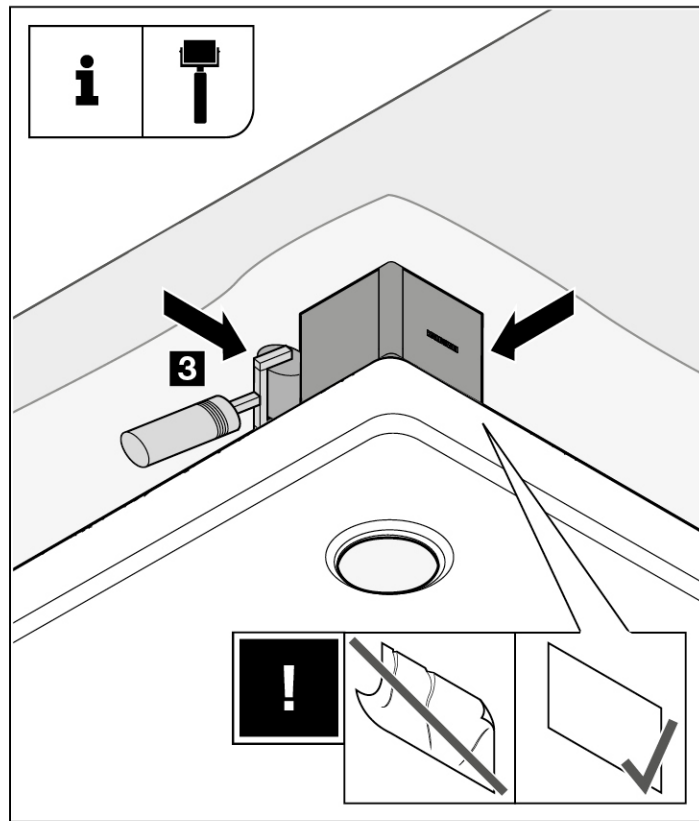
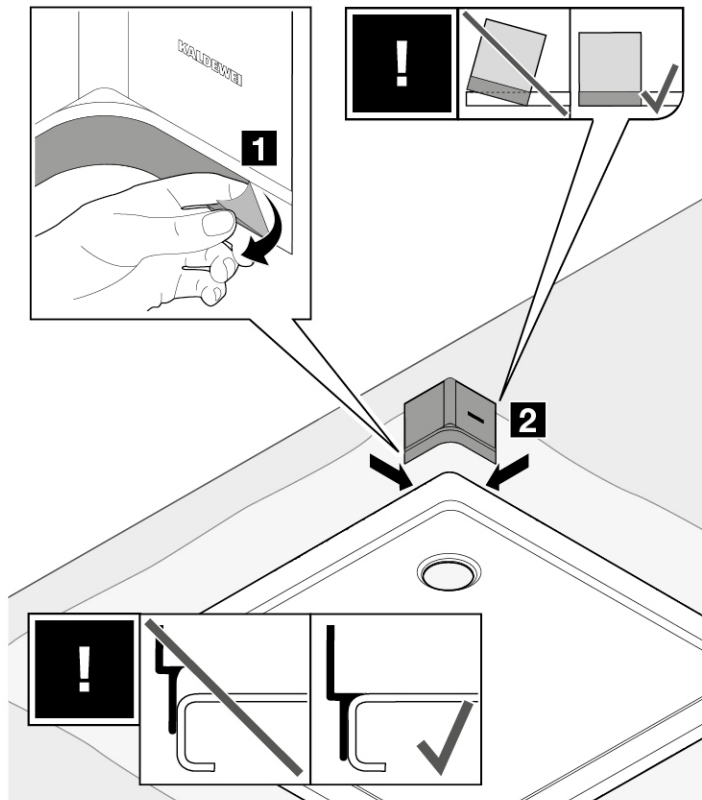

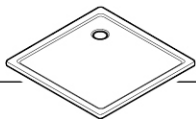
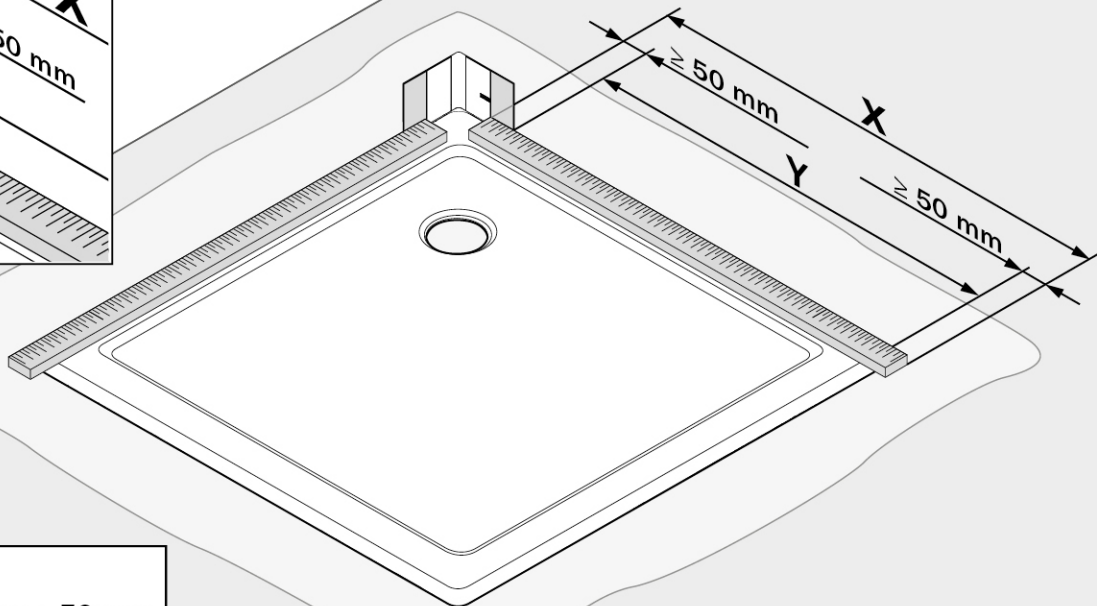
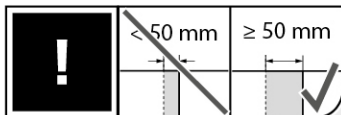
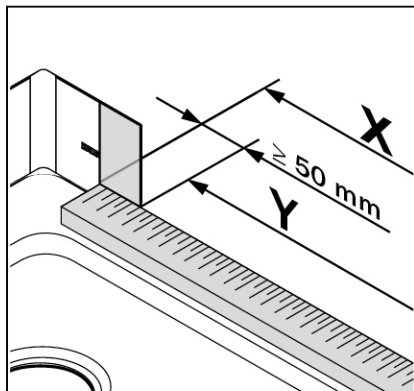
**A****6.****i** $X = Y + 50 \text{ mm} + 50 \text{ mm}$

Inch = mm x 0,0394



A 7.

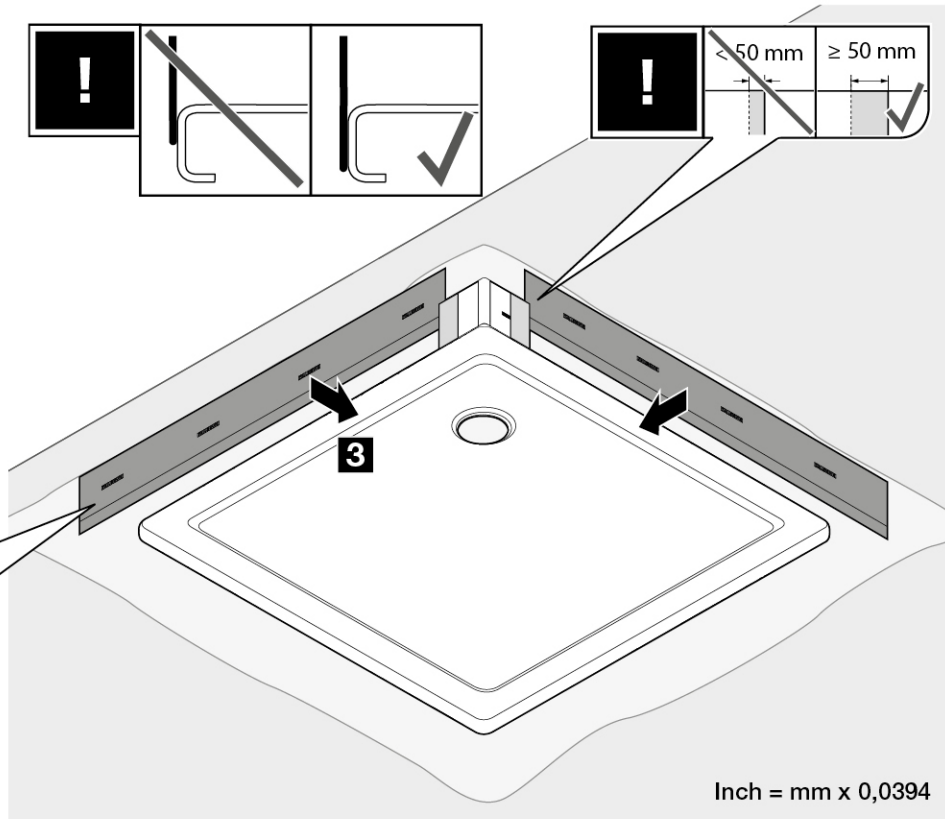
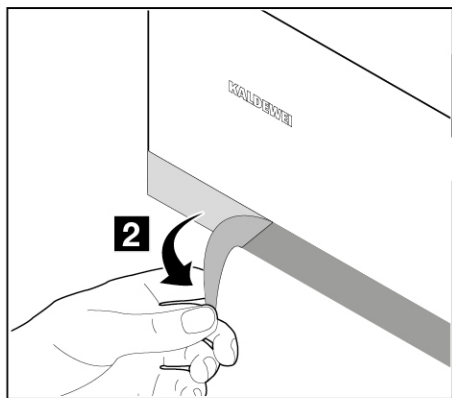
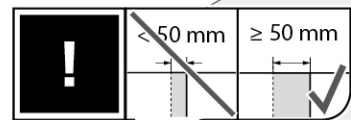
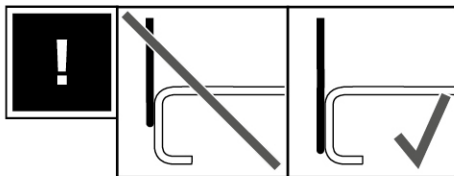
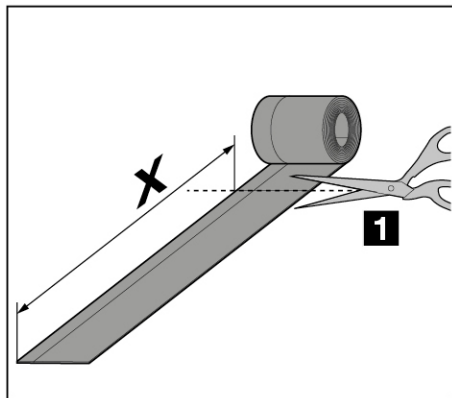

Inch = mm x 0,0394

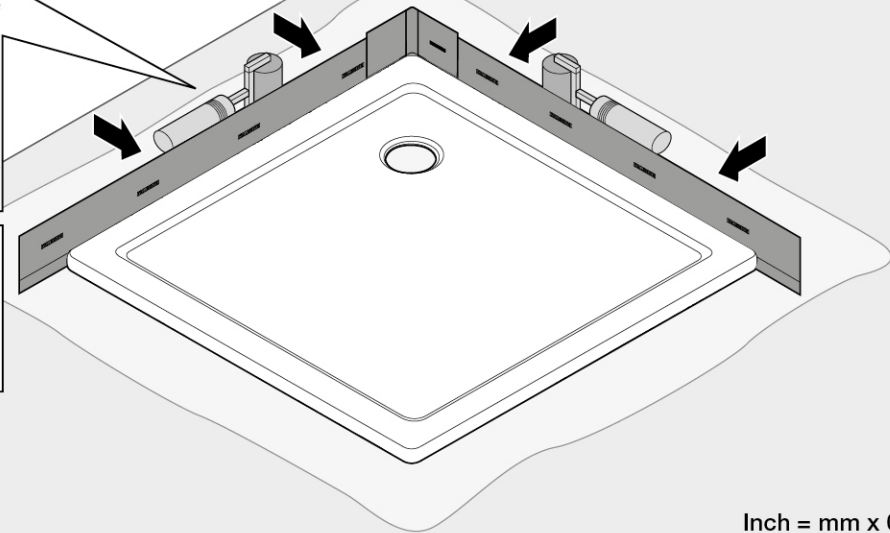
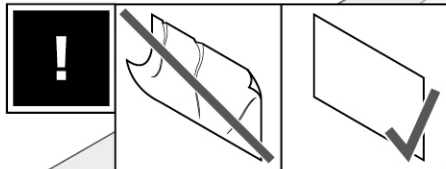
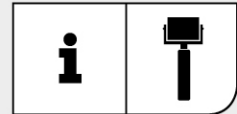
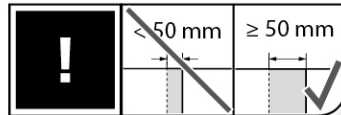
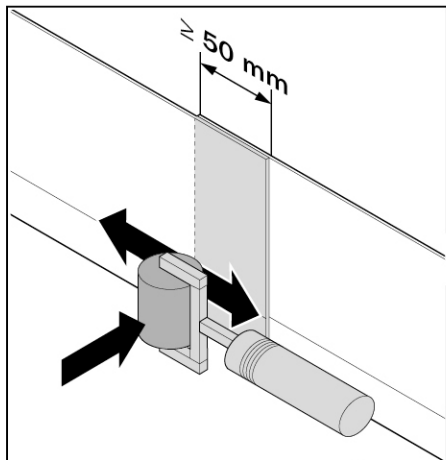
**A****8.**

Inch = mm x 0,0394

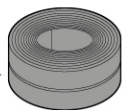

A 9.

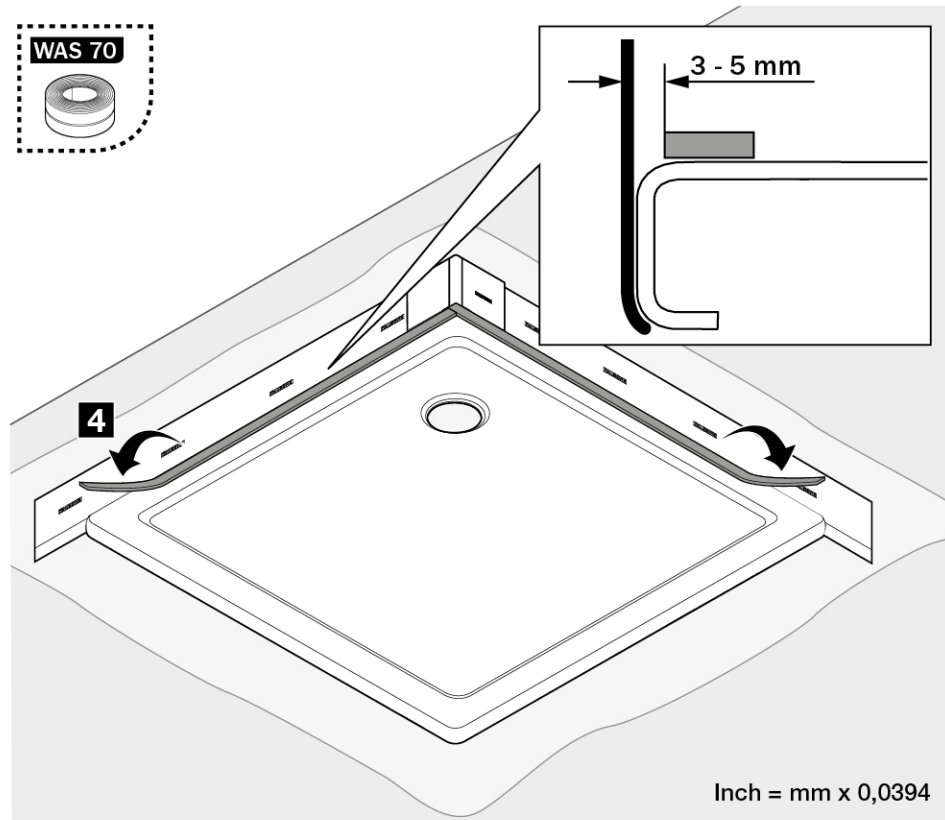
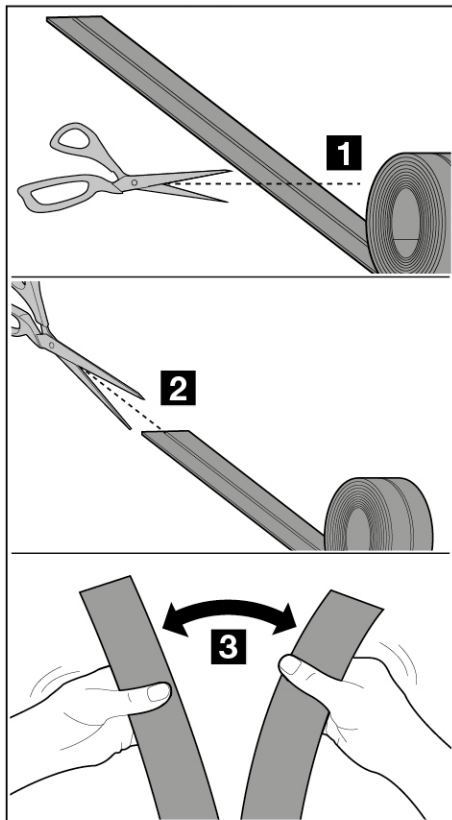

Inch = mm x 0,0394

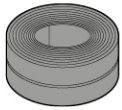

A 10.

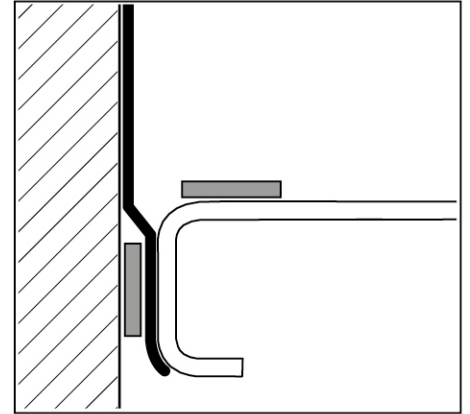
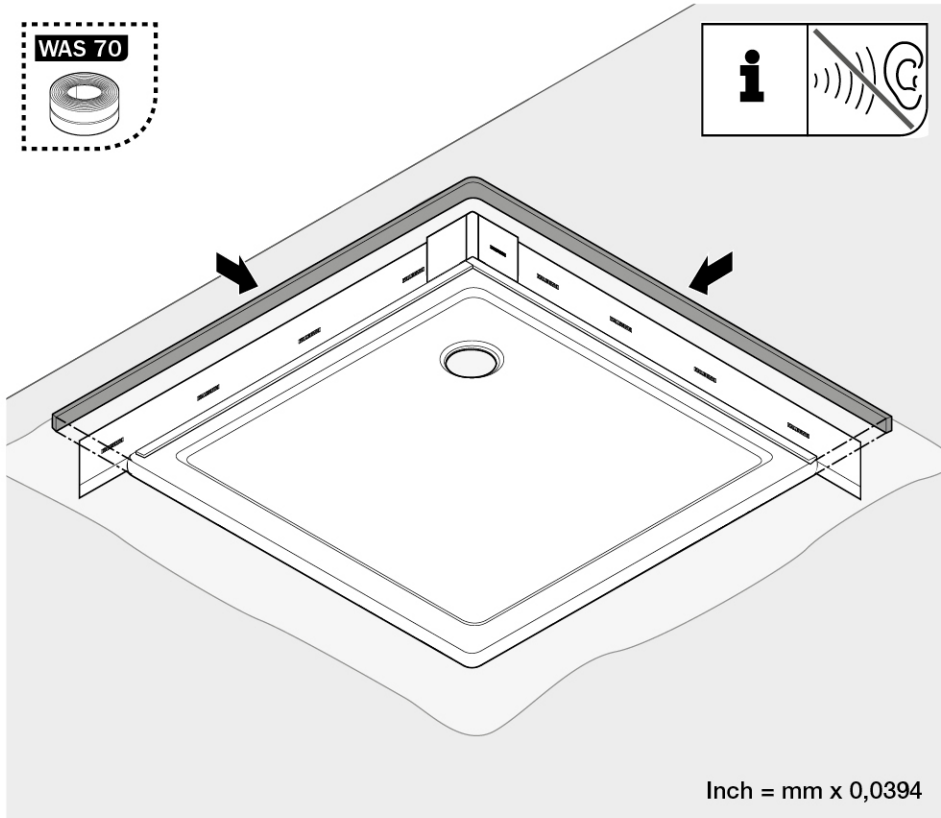
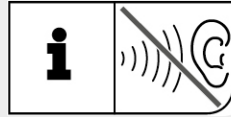

Inch = mm x 0,0394

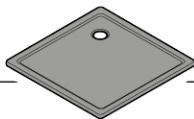

A 11.

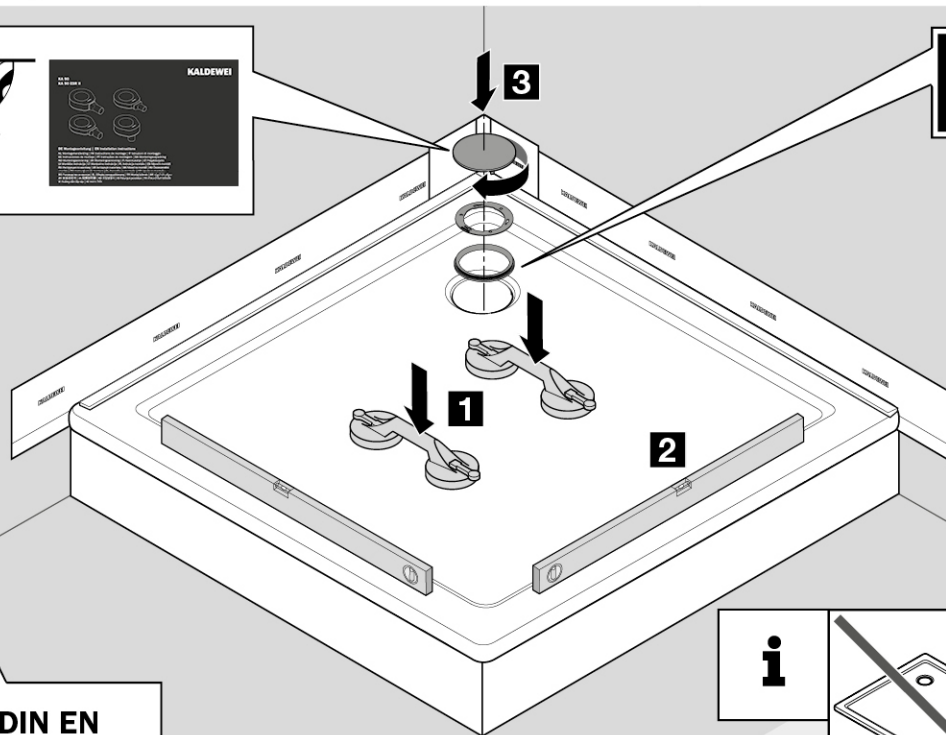
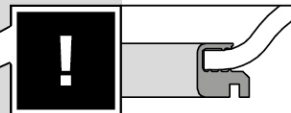

**DIN EN
18 157**

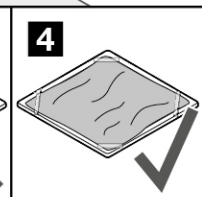
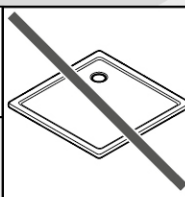

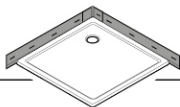
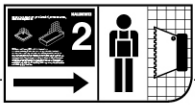

A 12.

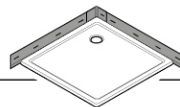
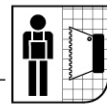

A 13.

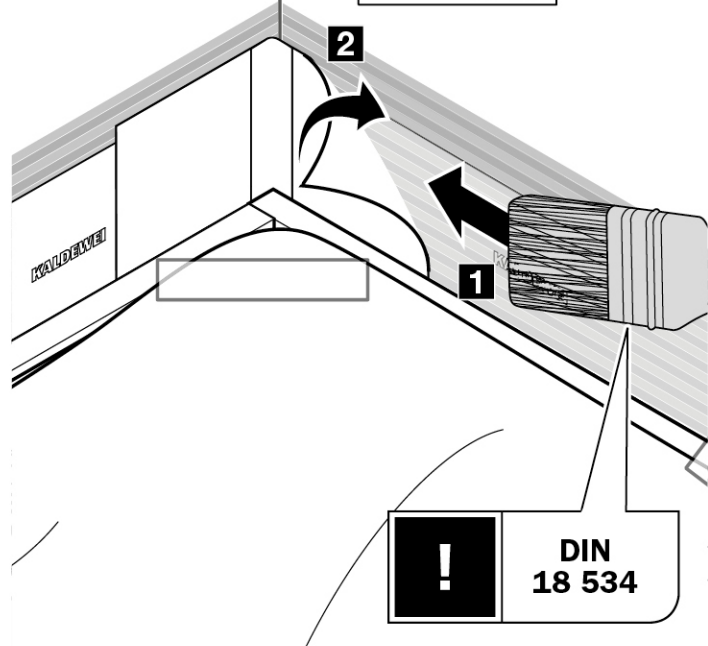
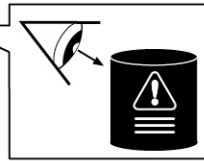
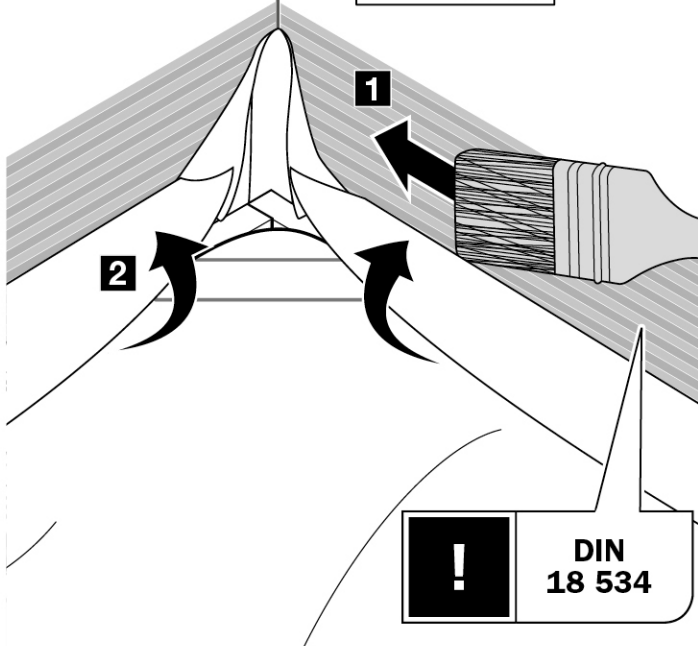
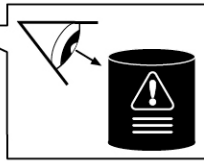
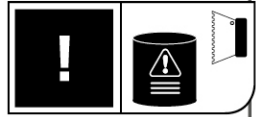

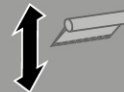
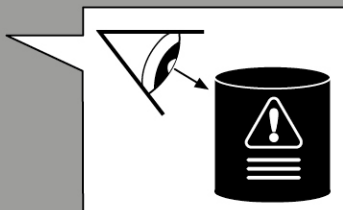
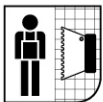

2



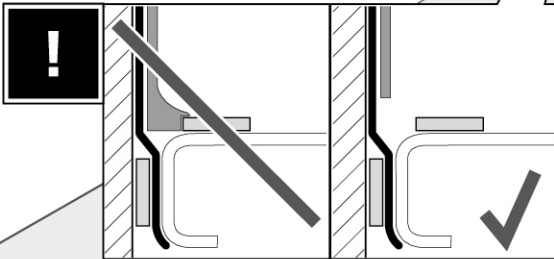
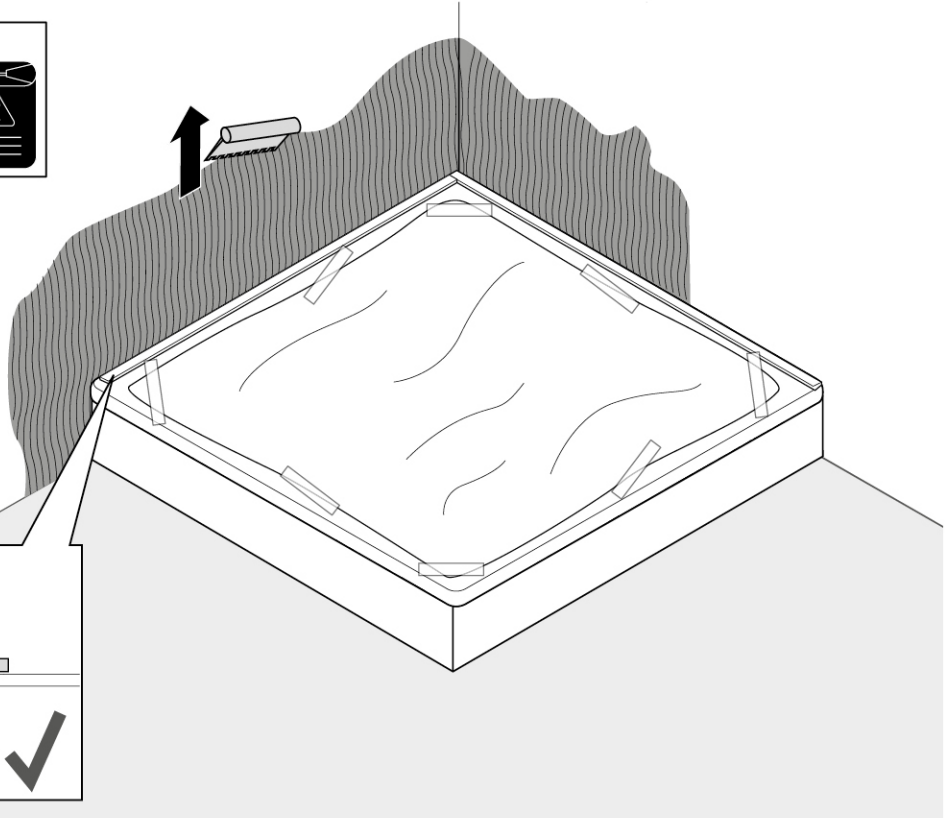
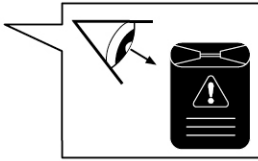
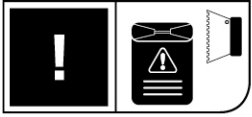
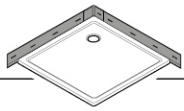

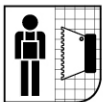

A 16.

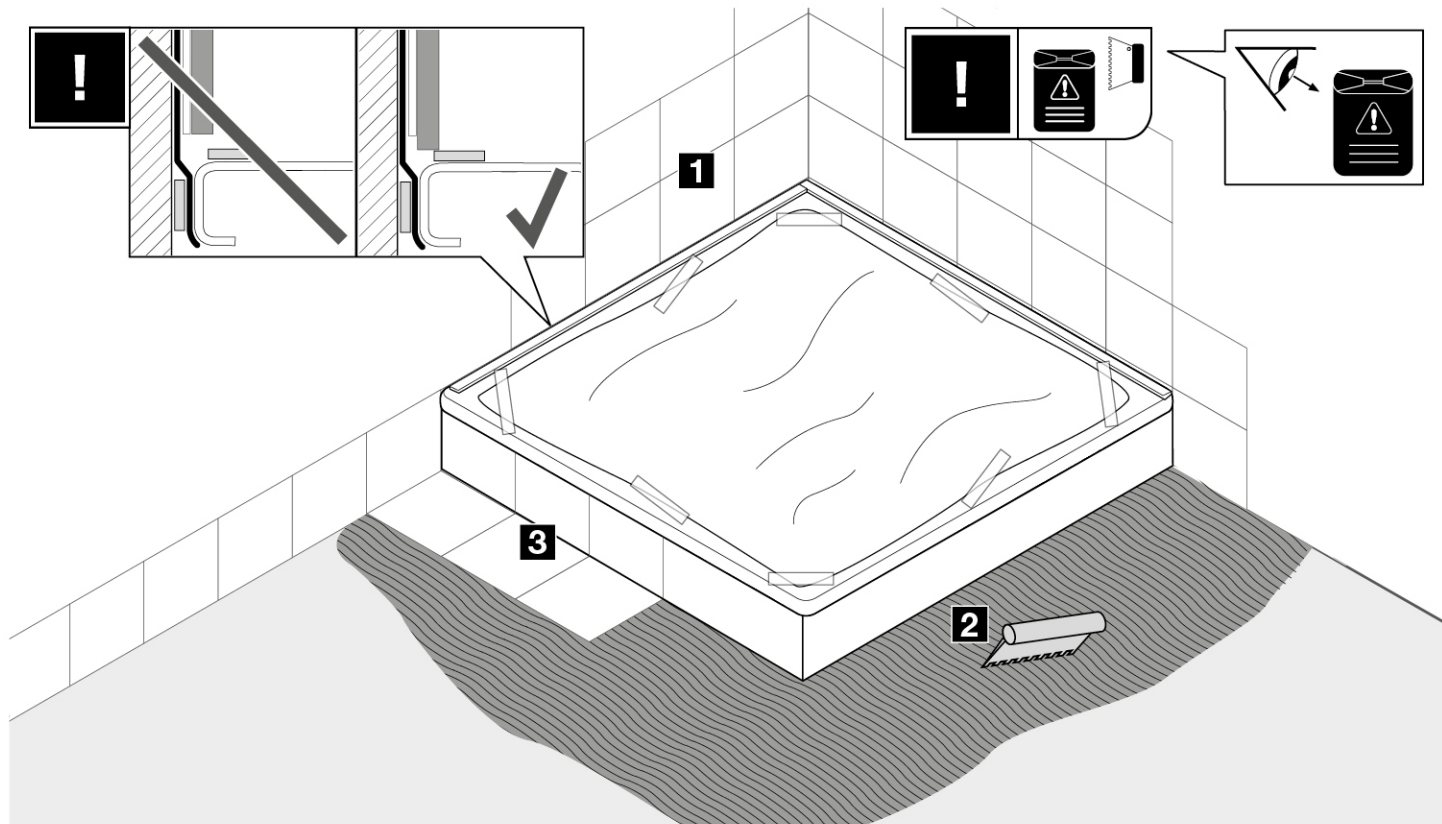

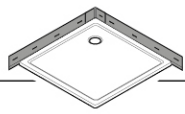

A 17.

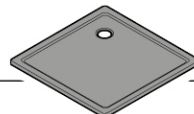

A 18.

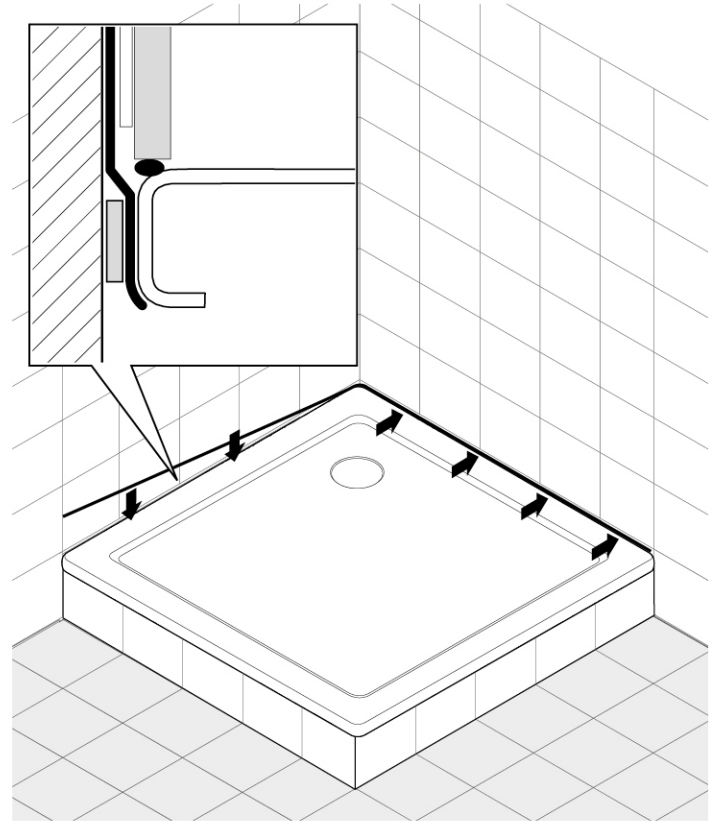
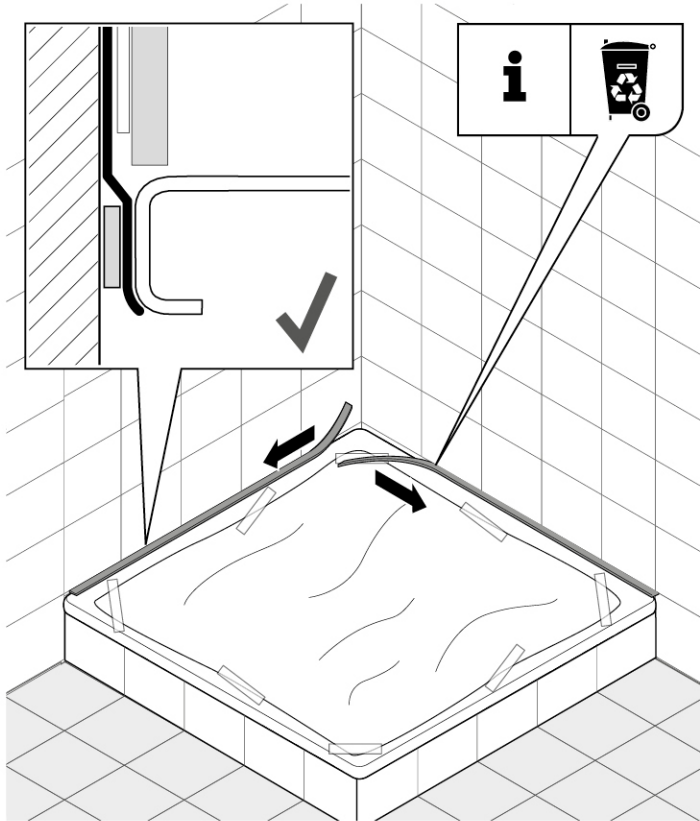

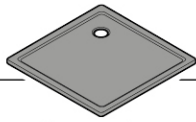
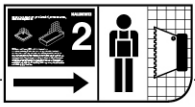

A 19.

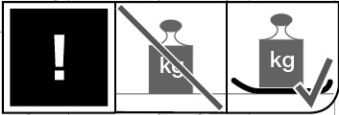

! DIN 52 460

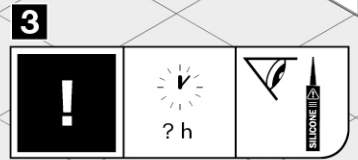
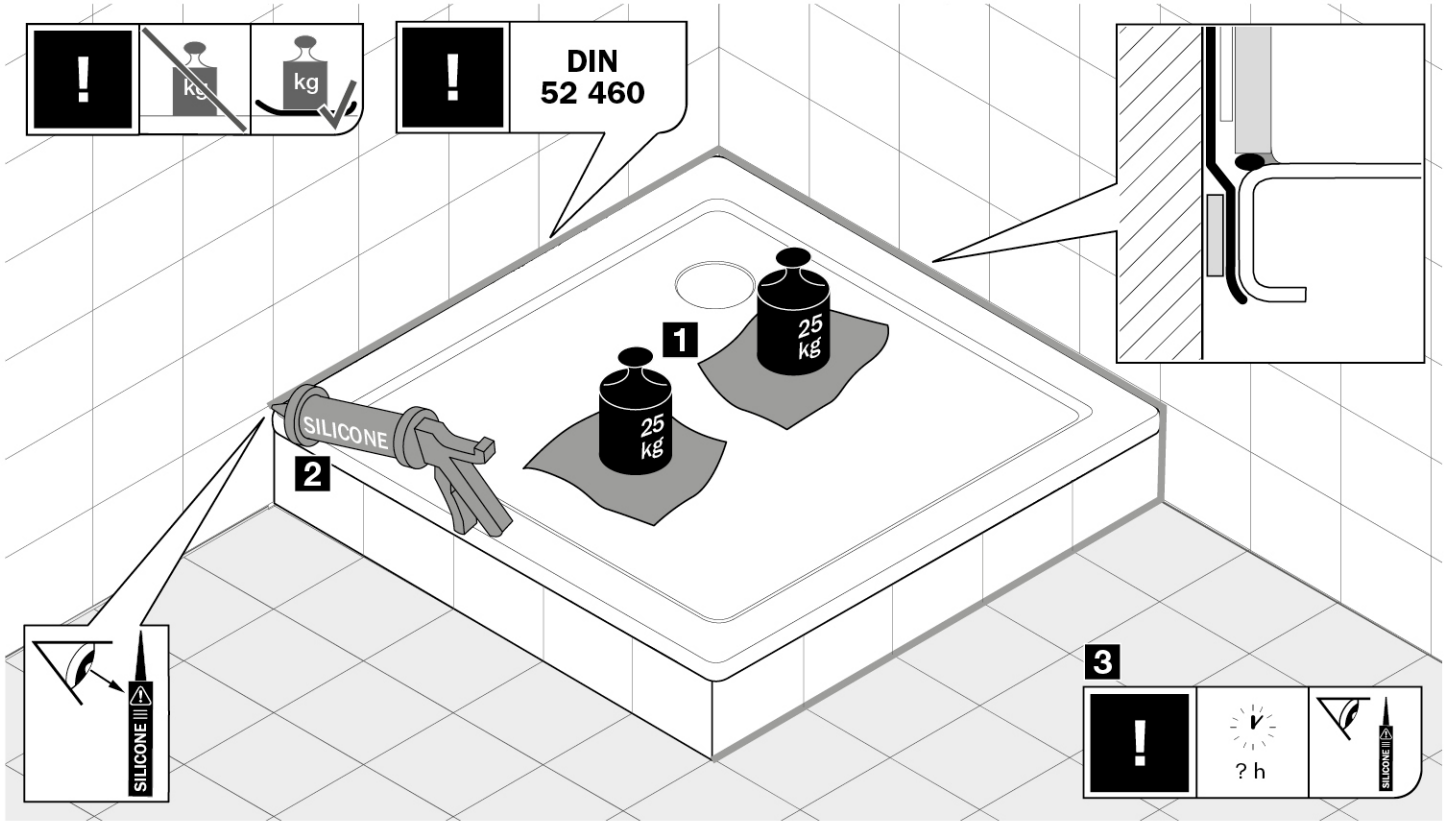
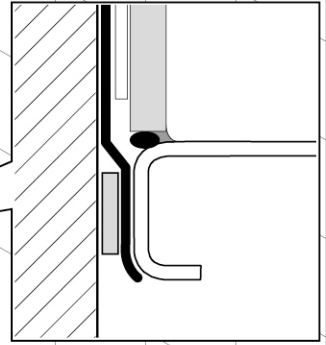

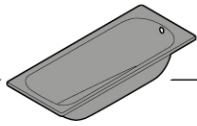

B **4.**

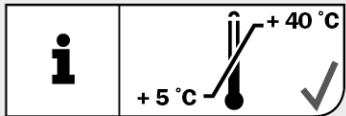
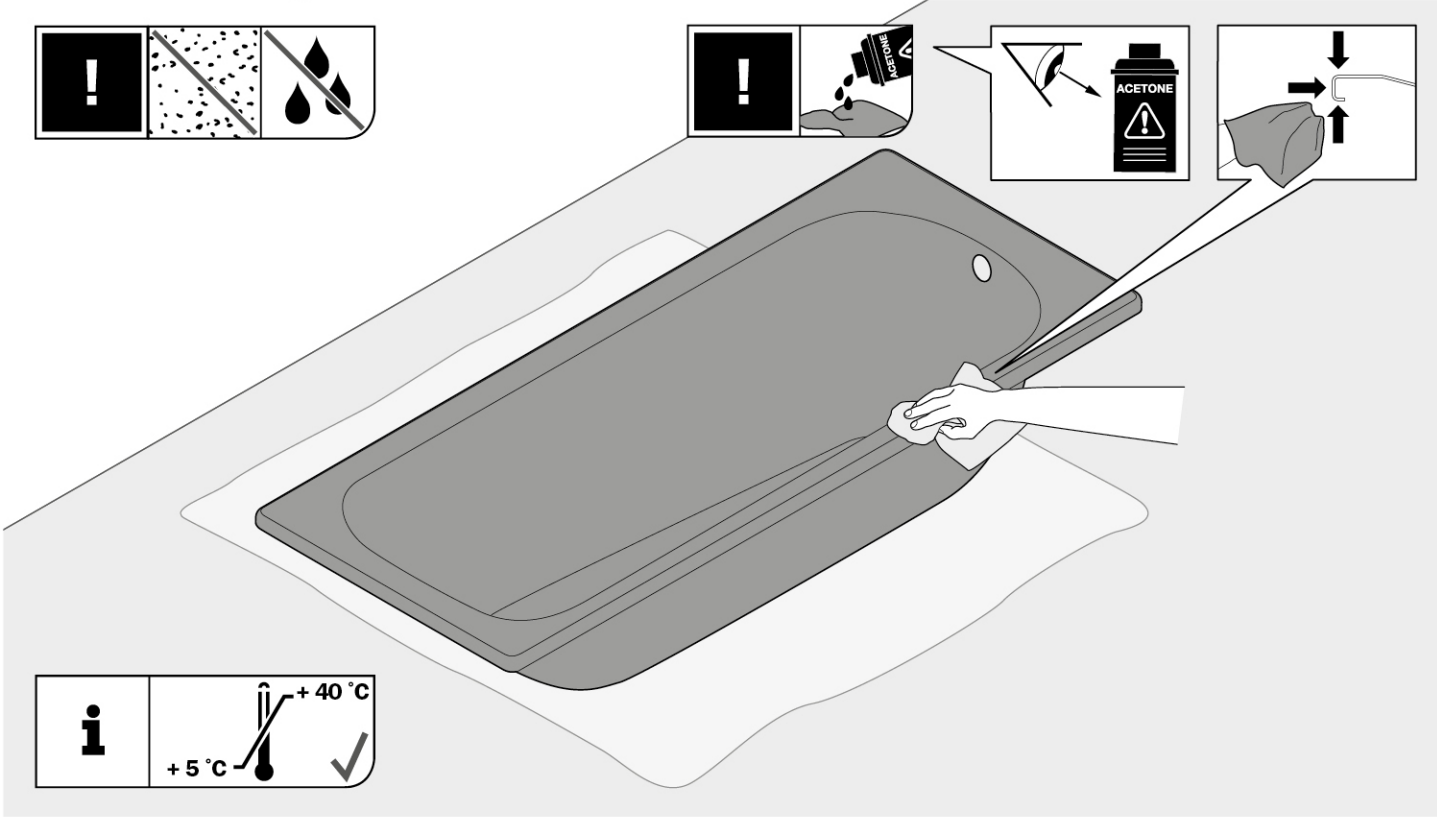
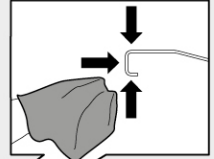
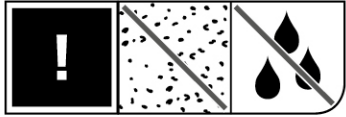

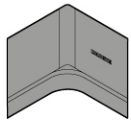

B 5.

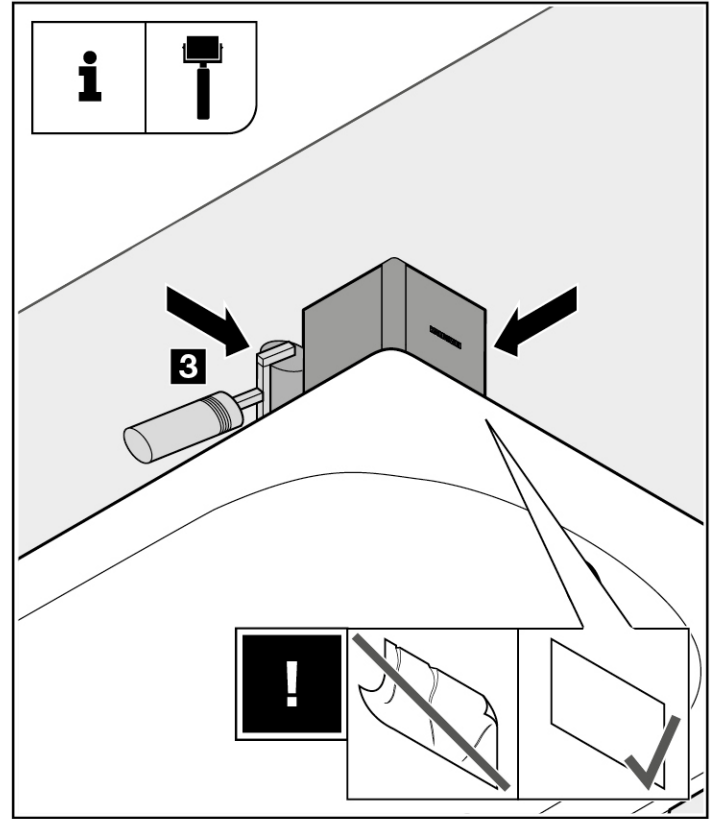
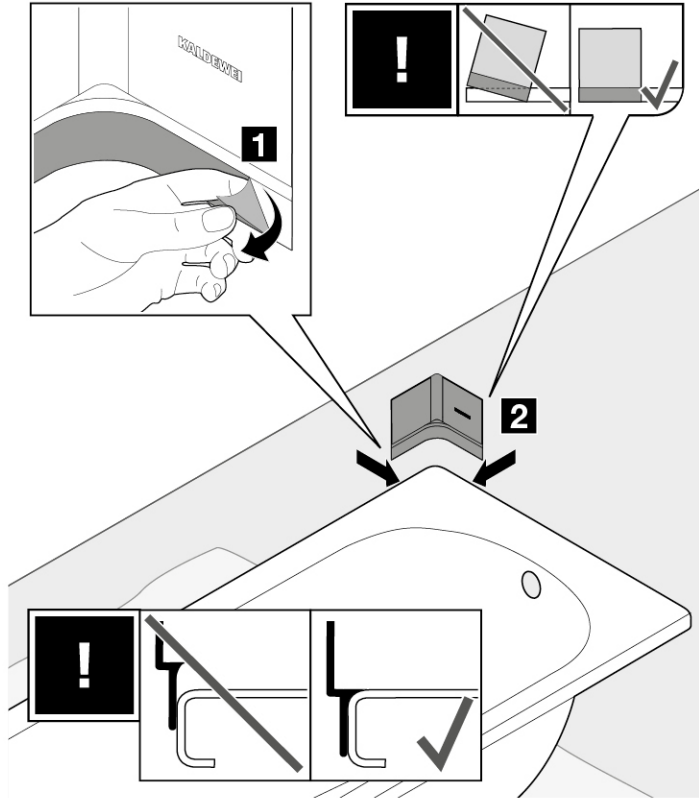

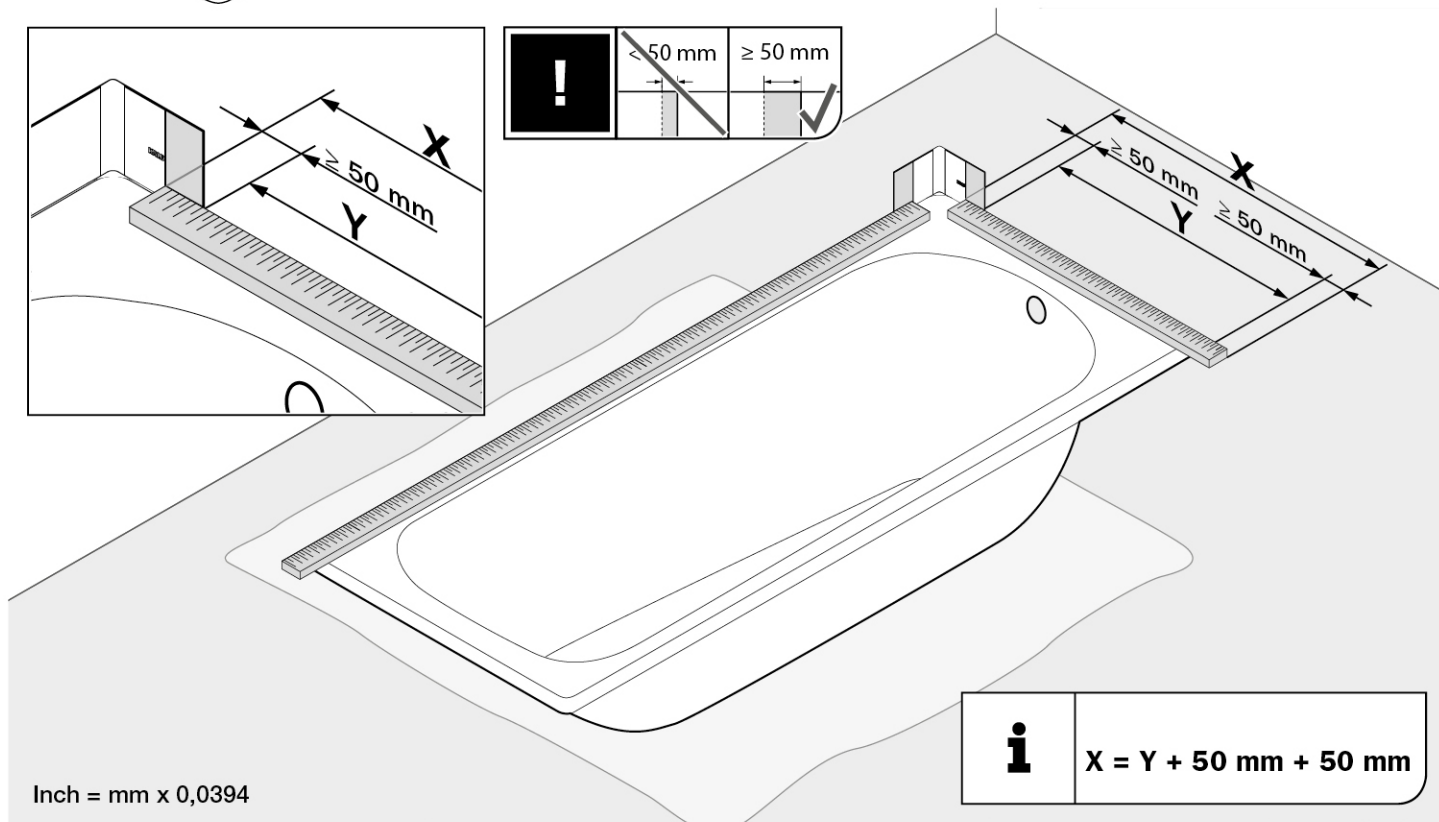
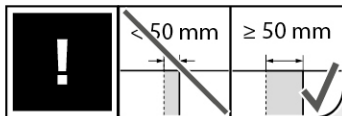
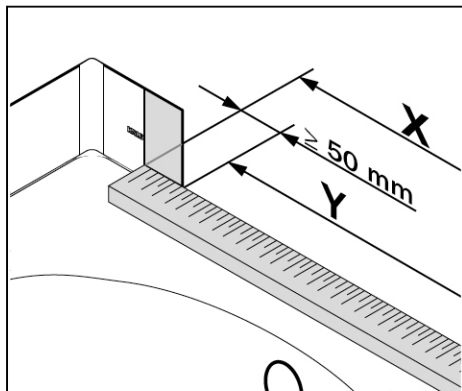
**B****6.**

$$X = Y + 50 \text{ mm} + 50 \text{ mm}$$

Inch = mm x 0,0394

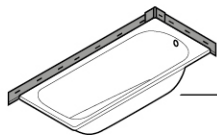

B 7.

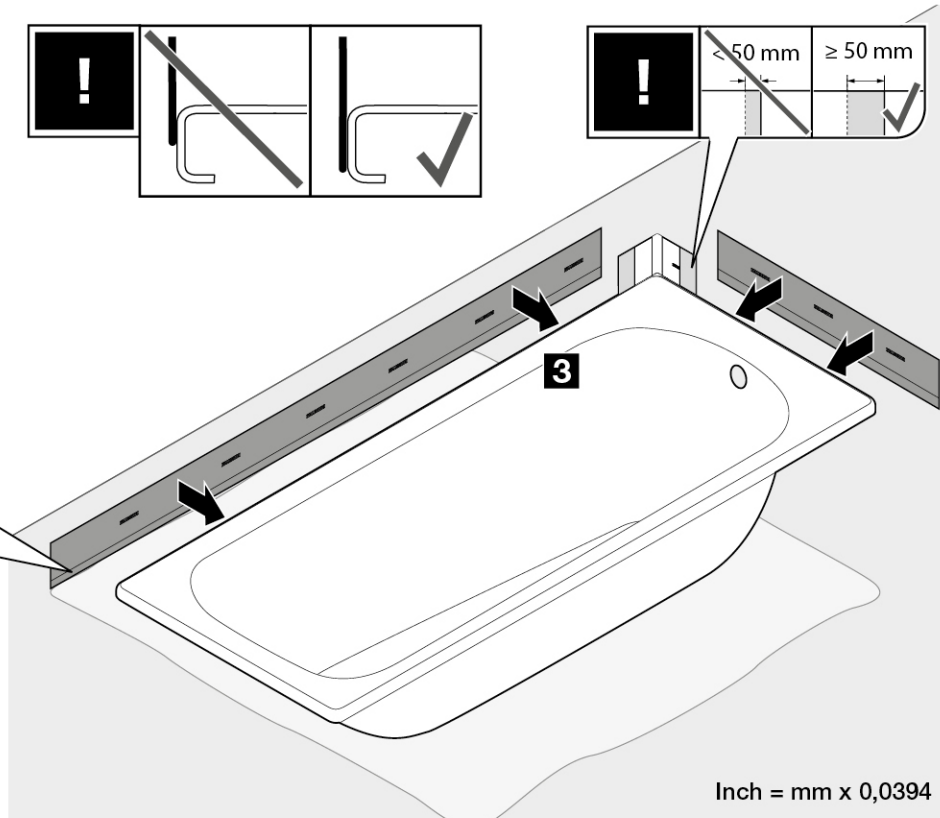
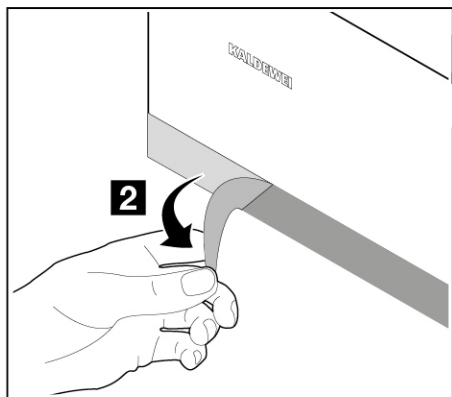
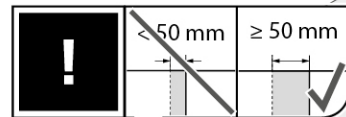
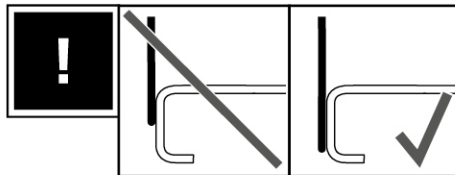
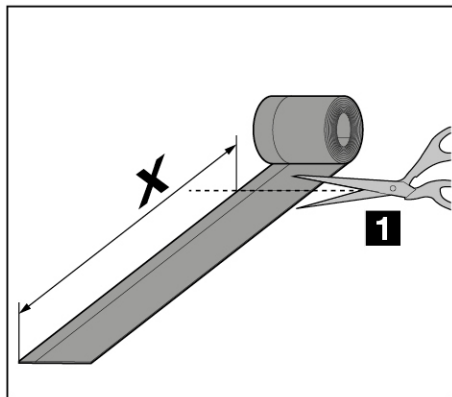

Inch = mm x 0,0394

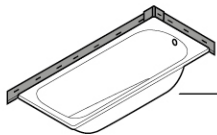
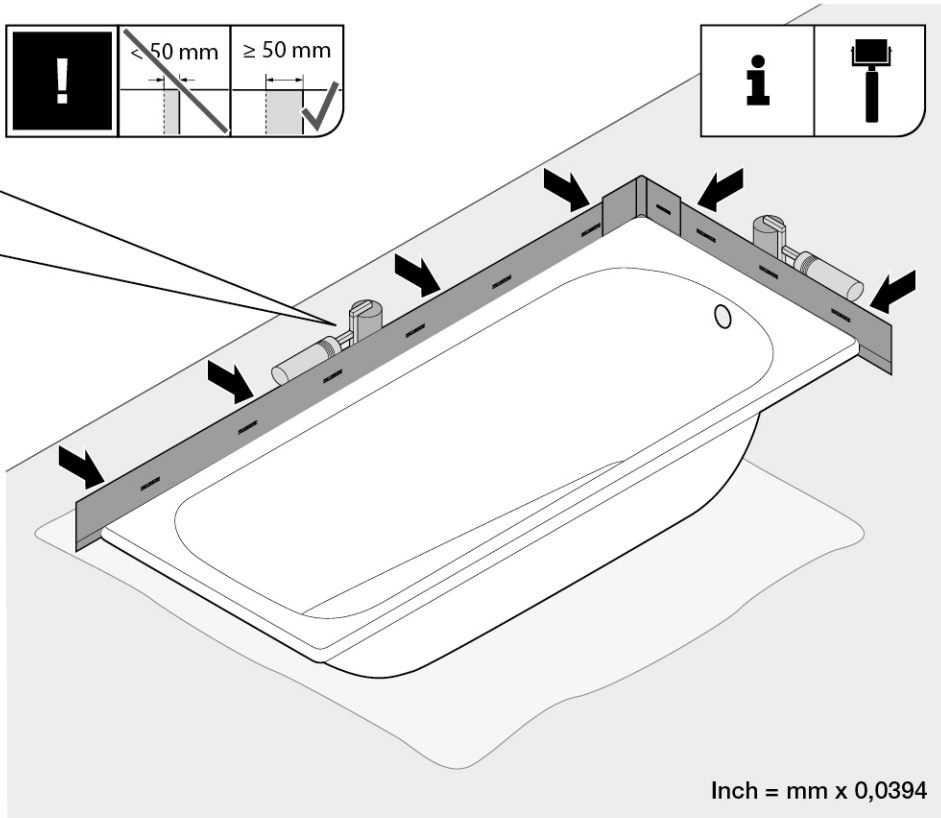
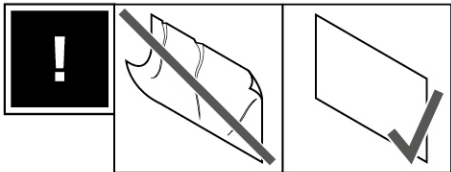
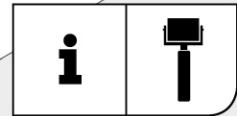
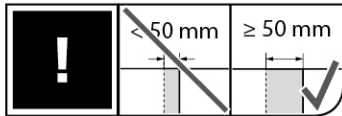
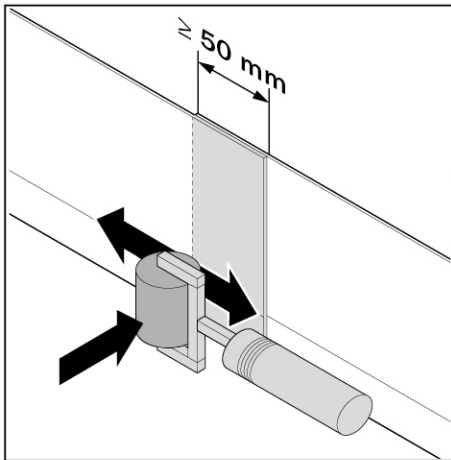
**B****8.**

Inch = mm x 0,0394

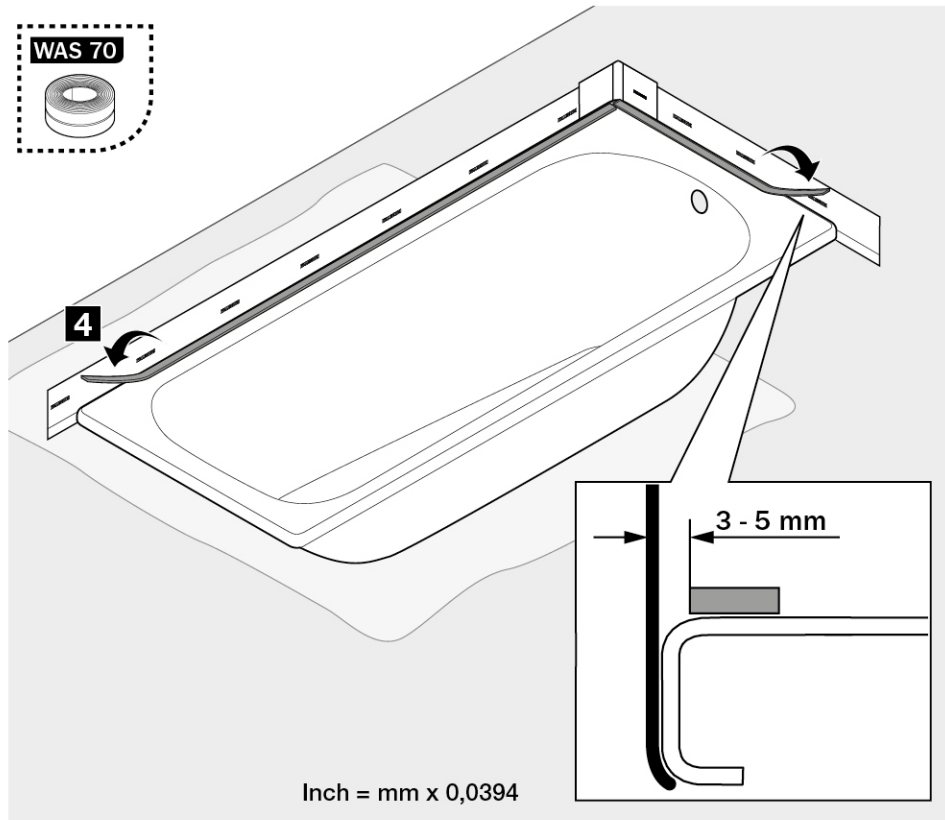
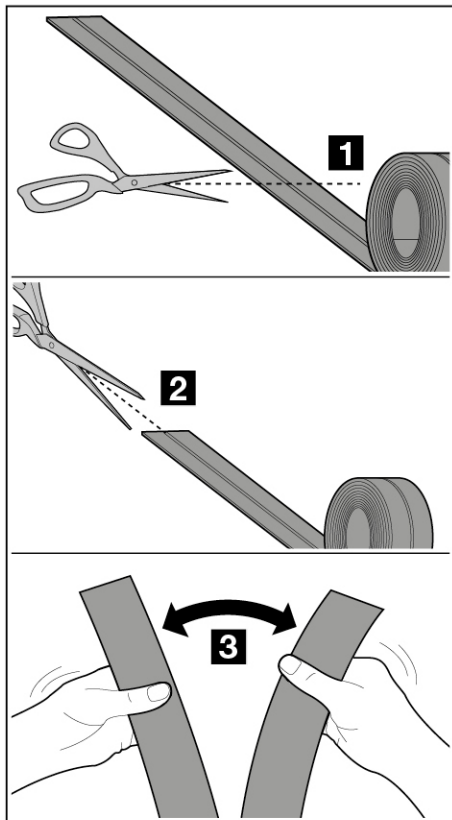
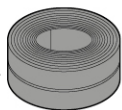

Inch = mm x 0,0394

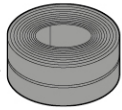

B 10.

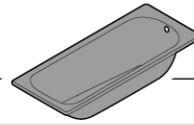

B 11.

WAS 70

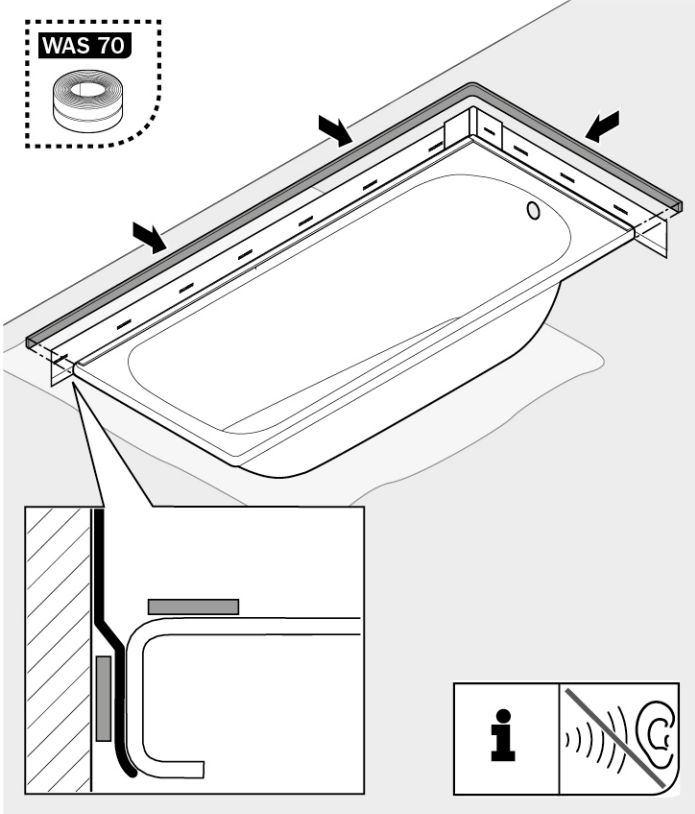

**DIN EN
18 157**

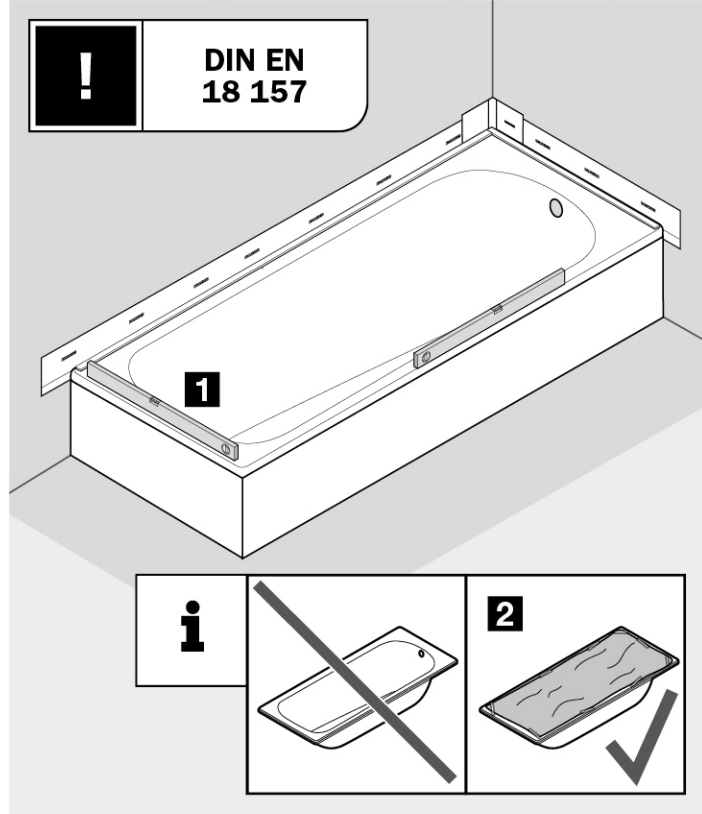

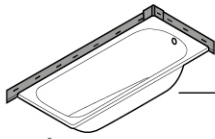
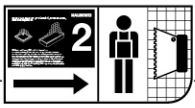

B 12.

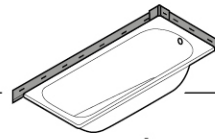
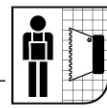

B 13.

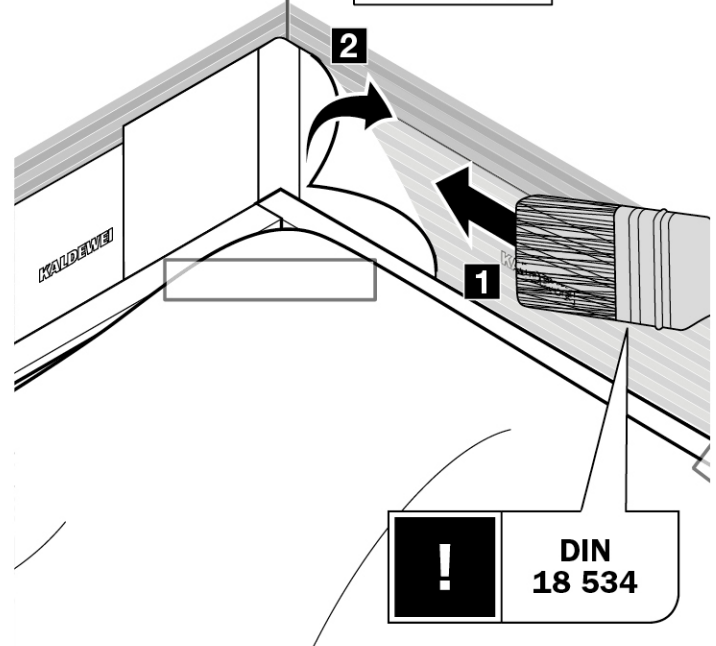
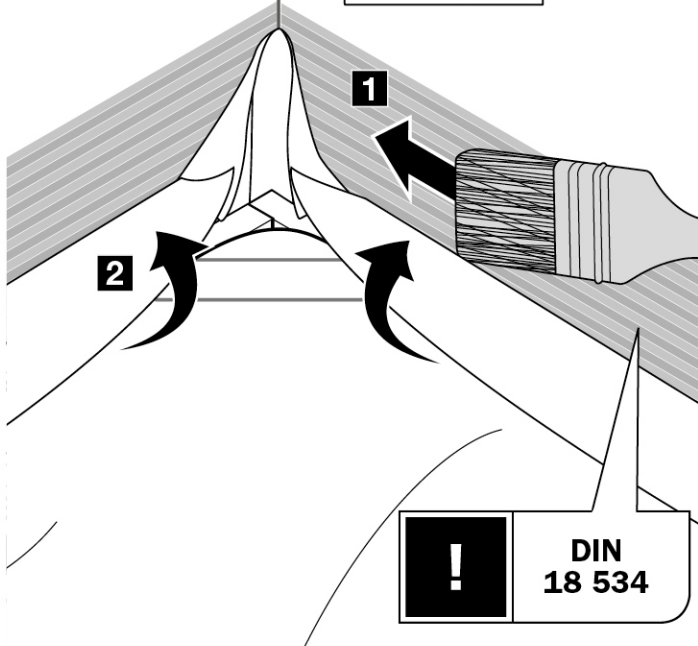
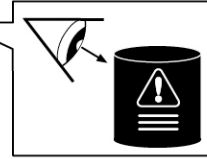
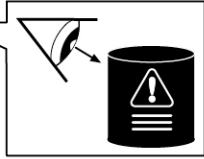
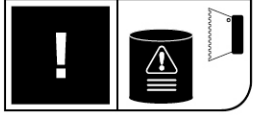

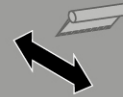
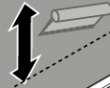
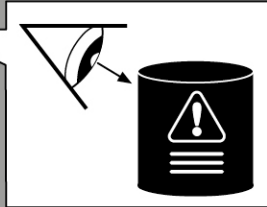
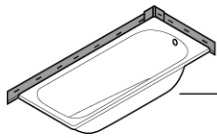
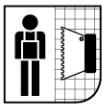

2

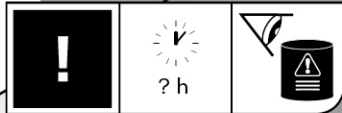

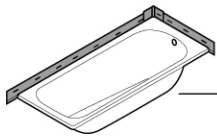
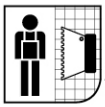

B 15.

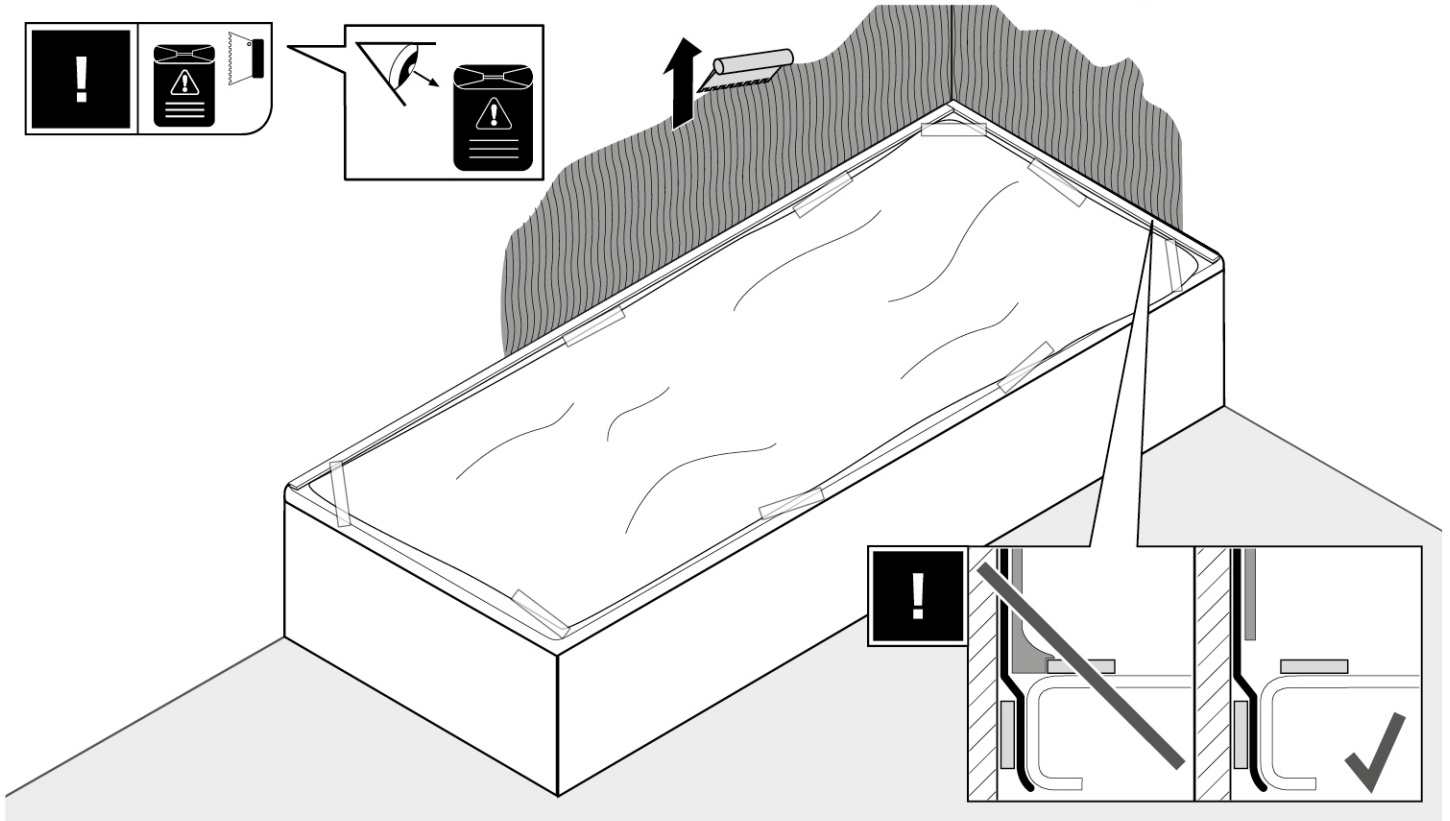
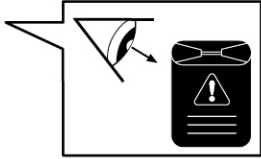
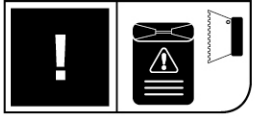

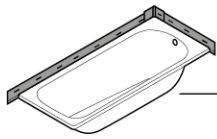
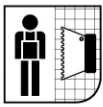

B 16.

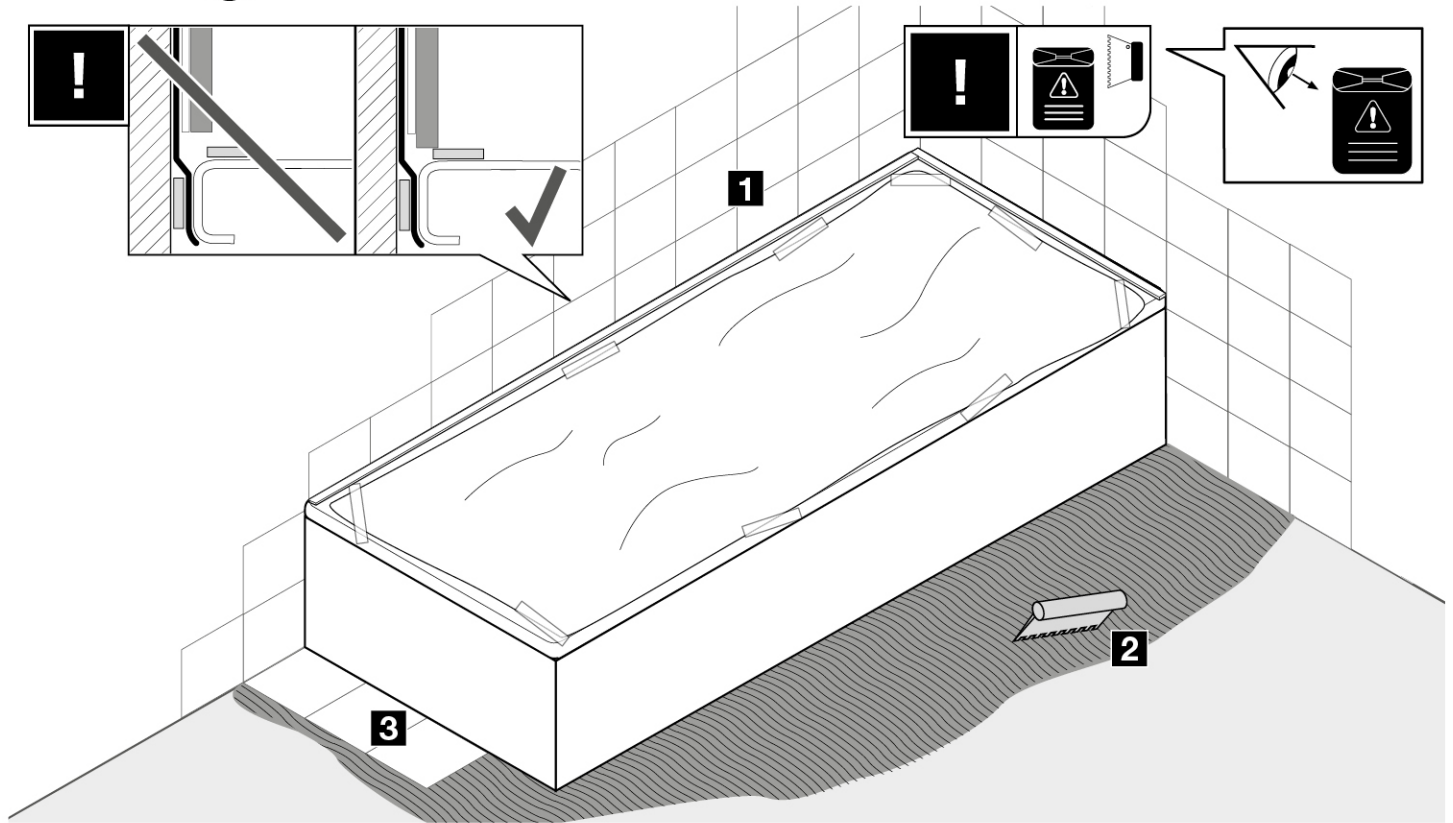
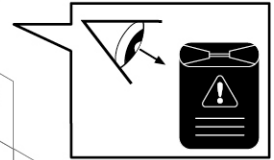
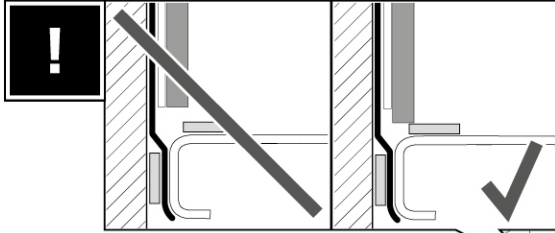

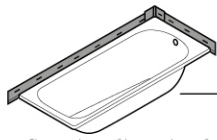
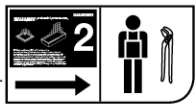

B 17.

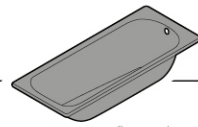

B 18.

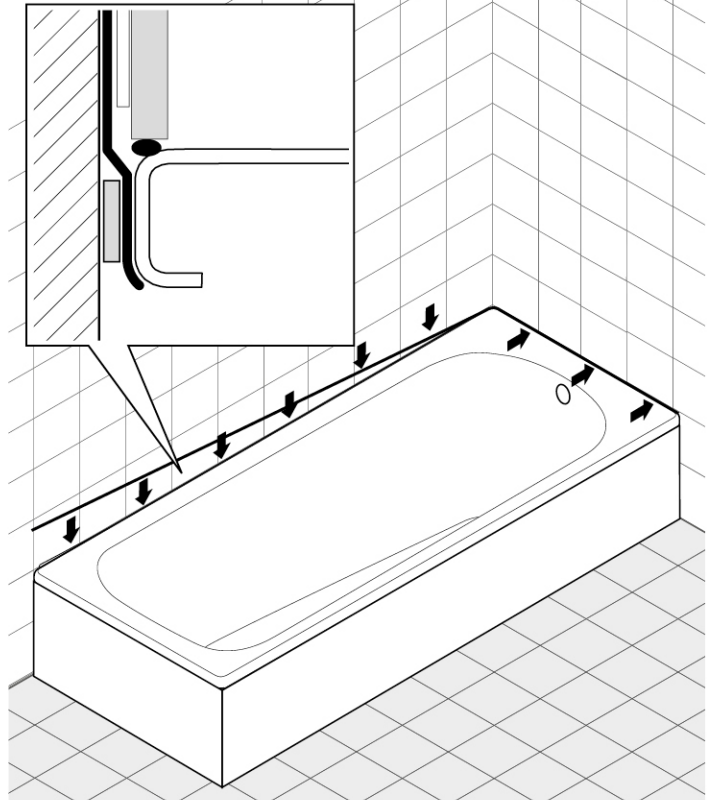
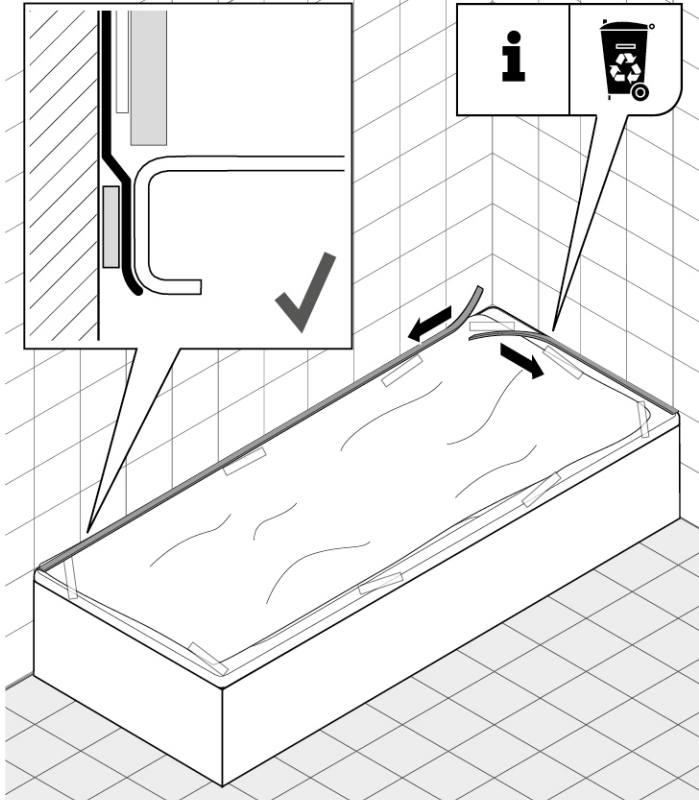

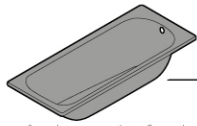
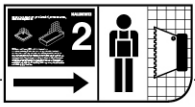

B 19.

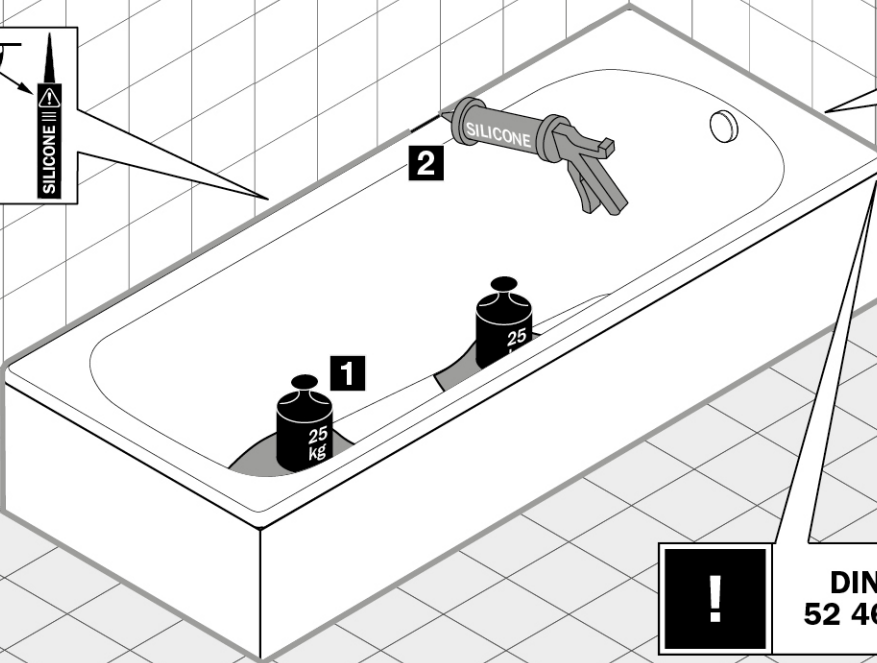
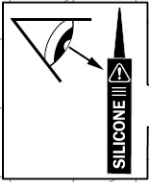

DIN 52 460

3



KALDEWEI



Franz Kaldewei GmbH & Co. KG
Beckumer Str. 33-35
D-59229 Ahlen

+49 2382 785 0

+49 2382 785 200

www.kaldewei.com

